



METAL DOORS & FRAMES  
ARCHITECTURAL WOOD DOORS  
ALUMINUM ENTRANCES  
COMMERCIAL HARDWARE:  
HINGES  
LOCKS  
EXIT DEVICES  
CLOSERS  
THRESHOLDS  
DOOR PROTECTION  
WEATHERSTRIP

# INDEX

2	Marketing Area Commercial Door Handing	9	Typical Exit Device Combinations Closers
3	Flush & DW Drywall Frames	10	Push/Pulls/Kickplates & Stops Weatherstripping & Thresholds
4	Prefinished Frames & Aluminum Entrances	11	Opening Order Checklist
5	Hollow Metal Doors & Stock Chart	12	Existing Opening Dimension Charts
6	Wood Doors & Door & Frame Options		
7	Hinges & Locksets		
8	Deadlocks, Smart Locks & Exit Devices		

## MARKETING AREA

Southern Indiana, Southern Illinois, and Western Kentucky as well as parts of Missouri and Tennessee.

Our main offices, warehouse and fabrication facilities are located at 600 North Sixth Ave; Evansville, IN



## COMMERCIAL DOOR HANDING

Viewed from the exterior (keyed) side of the opening

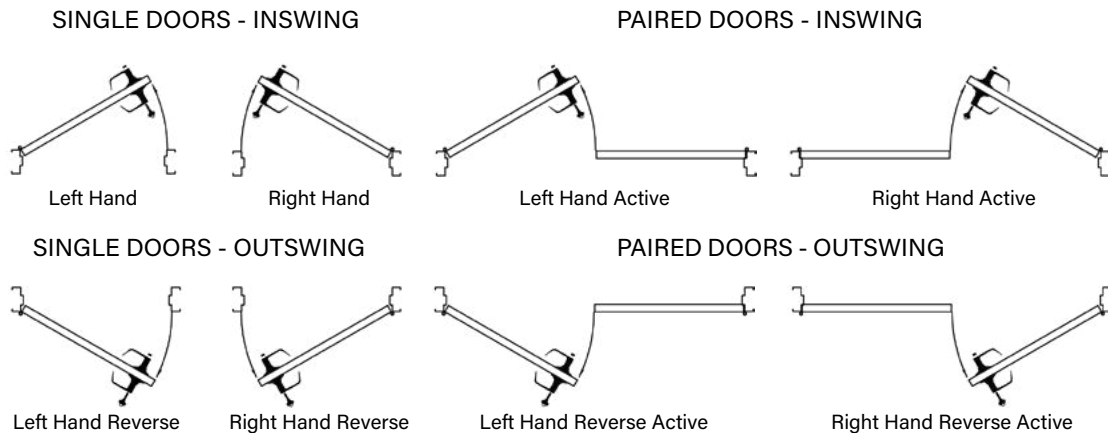

# Select Your Frame

## FLUSH FRAMES

"F" Series 16ga, primed steel in 5-3/4", 6-3/4", 7-3/4", 8-1/4", and 8-3/4" Jamb depths for 6'8" and 7'0" doors. Fire rated frames also available. Other jamb depths and heights are available, contact our office for availability.



F Series Rough Openings

Type	O.A. Fr Width +	O.A. Fr Height+
Butted Masonry	1/2"	1/4"
Wood/Metal Stud	1/4"	1/4"

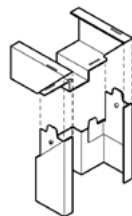

KD Frame  
Corner (std)

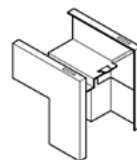

Welded Frame  
Corner Option

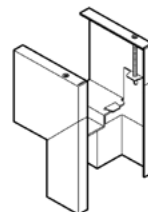

4" Head  
Option

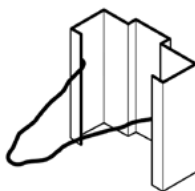

Wire Masonry  
Anchor

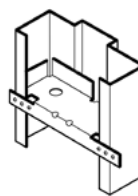

Wood Stud  
Anchor

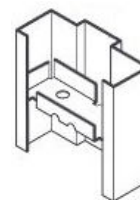

Steel Stud  
Anchor

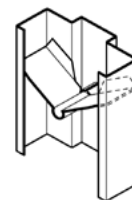

Existing Wall  
Anchor

## Special Elevation Options

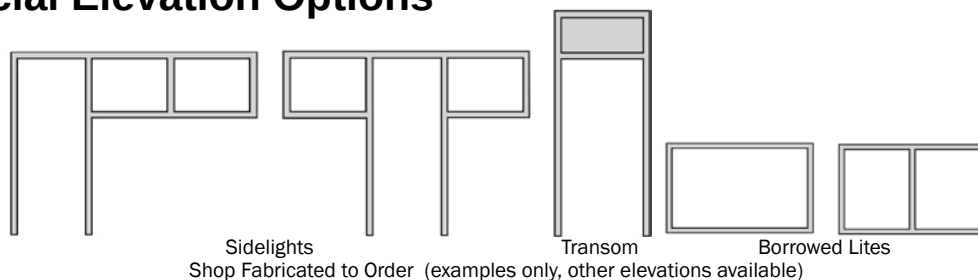

## DRYWALL FRAMES

"DW" Series 16ga, primed steel in 5-7/8" Jamb depth (3-5/8" metal stud width) are available, contact our office for availability.



DW Series Rough Openings

Type	Nom Door Width +	Nom Door Height+
Wood/Metal Stud	2"	1"

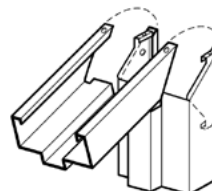

KD Corner

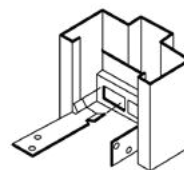

Base  
Anchor

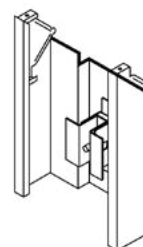

Compression  
Anchor

# PREFINISHED FRAMES

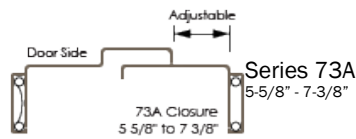
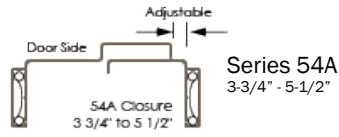
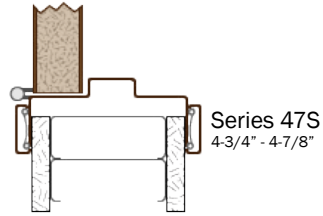
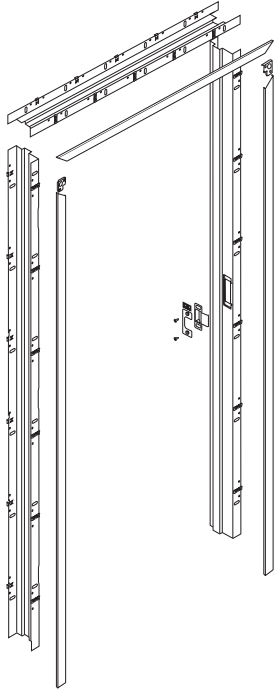

"47S" Series - 20 gauge		
Western White*		
Width	6'8" Rough Opening	7'0" Rough Opening
2'6"	31-1/4" x 81"	31-1/4" x 85"
2'8"	33-1/4" x 81"	33-1/4" x 85"
3'0"	37-1/4" x 81"	37-1/4" x 85"
6'0"	73-1/4" x 81"	73-1/2" x 85"
"54A" and "73A" Series - 18 gauge		
Western White*		
3'0"	37-1/4" x 81"	37-1/4" x 85"
6'0"	73-1/4" x 81"	73-1/2" x 85"

\* Other colors available by special order

# ALUMINUM ENTRANCES

Kawneer aluminium entrances are stocked in both Clear and Dark Bronze Anodized finishes in the 190 Series narrow stile door design. Doors are 1-3/4" thick and frames are 4-1/2" deep



Entrance Package includes:

- Top/Bottom Offset Pivots
- Cylinder deadlock (thumb turn inside)
- Push/Pulls
- Surface Closer
- 3/16" or 1" Clear I.G
- Flushbolts (on pairs)
- Threshold
- Door Sweeps

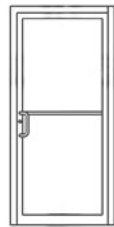

Standard Single

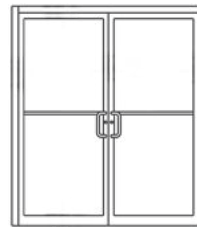

Standard Pair

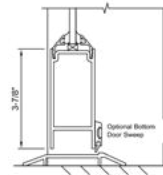
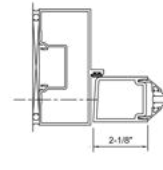
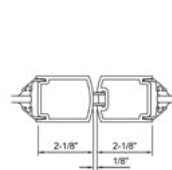
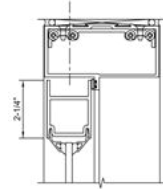

A few of the types of Special Elevations that are possible

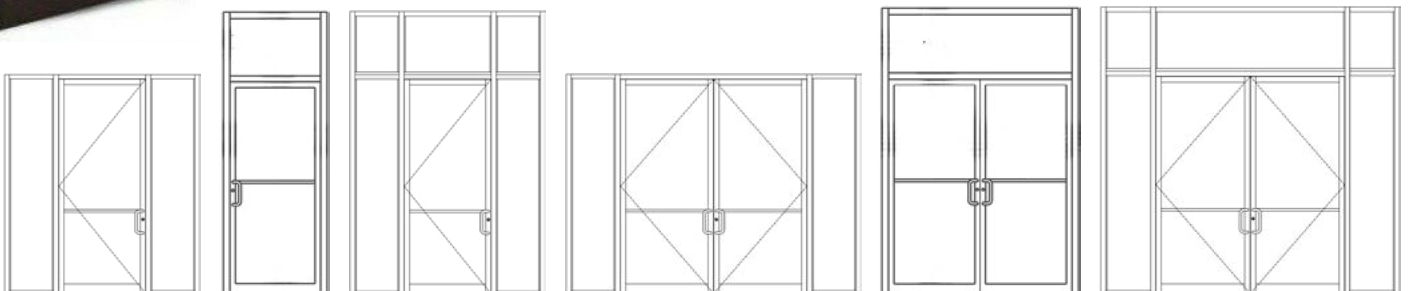

# Select Your Door

## Hollow Metal Doors, Primed, 18 ga



Stock doors are prepped for 161 cylindrical locks and mortised for (3) 4-1/2" hinges.

Light duty 20 ga doors are available in 3068 and 3070.

Polystyrene core doors are available in 3068 and 3070.

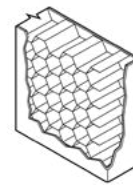

Honeycomb Core Standard



161 Lock Prep Std

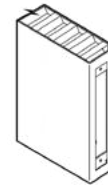

86ED Lock Prep Option

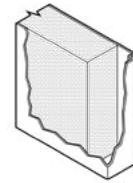

Polystyrene Core Option

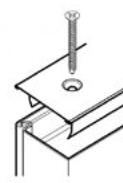

Steel Top Cap Option

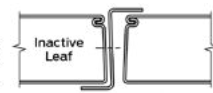

Steel Z Astragal Option (Inactive Leaf)

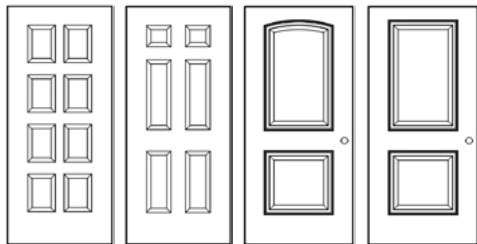

8-Panel 6-Panel HD2 Style HD2A Style  
Special Order Embossed Steel Options

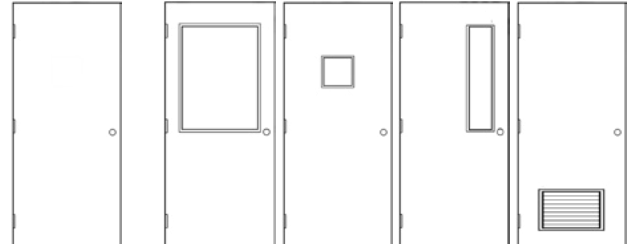

"F" Style Standard "G" Style "V" Style "N" Style Louvered  
Shop Modified Options

### STOCK DOOR SIZE CHART

	20 Ga Hollow Metal				18 Ga Hollow Metal						
	F	G	V	N	F	G	V	N	Insul*	Fire Rated 1-1/2 or 3Hr	
Shop Installed**		x	x	x		x	x	x			
Door Style	F	G	V	N	F	G	V	N	F	F	V
2668					<b>x</b>	<b>x</b>	<b>x</b>	<b>x</b>		<b>x</b>	<b>x</b>
2868					<b>x</b>	<b>x</b>	<b>x</b>	<b>x</b>		<b>x</b>	<b>x</b>
3068	<b>x</b>	<b>x</b>	<b>x</b>	<b>x</b>	<b>x</b>	<b>x</b>	<b>x</b>	<b>x</b>	<b>x</b>	<b>x</b>	<b>x</b>
3668					<b>x</b>	<b>x</b>	<b>x</b>	<b>x</b>		<b>x</b>	<b>x</b>
4068					<b>x</b>	<b>x</b>	<b>x</b>	<b>x</b>		<b>x</b>	<b>x</b>
2670					<b>x</b>	<b>x</b>	<b>x</b>	<b>x</b>		<b>x</b>	<b>x</b>
2870					<b>x</b>	<b>x</b>	<b>x</b>	<b>x</b>		<b>x</b>	<b>x</b>
3070	<b>x</b>	<b>x</b>	<b>x</b>	<b>x</b>	<b>x</b>	<b>x</b>	<b>x</b>	<b>x</b>	<b>x</b>	<b>x</b>	<b>x</b>
3670					<b>x</b>	<b>x</b>	<b>x</b>	<b>x</b>		<b>x</b>	<b>x</b>
4070					<b>x</b>	<b>x</b>	<b>x</b>	<b>x</b>		<b>x</b>	<b>x</b>

\* Insulated doors have Polystyrene cores with Galvanized steel faces

\*\* Lite kits are shop installed in Flush doors

# Architectural Grade Unfinished Wood Doors

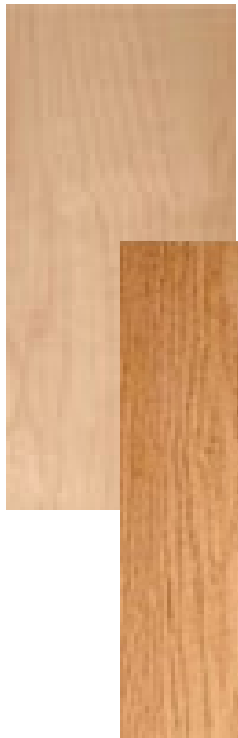

1-3/4" thick particleboard core\* doors are 3-ply construction with 1-1/8" matching hardwood stiles and rails and premachined for Steelcraft hinge locations.

\* 90 minute doors have a mineral core

Rotary Cut Natural Birch

Plain Sliced Red Oak

Wood Door Stock Chart

Fire Rating	Rotary Cut Natural Birch		Plain Sliced Red Oak	
	20 min*	90 min**	20 min*	90 min**
2668	<b>X</b>		<b>X</b>	
2868	<b>X</b>		<b>X</b>	
3068	<b>X</b>	<b>X</b>	<b>X</b>	<b>X</b>
2670	<b>X</b>		<b>X</b>	
2870	<b>X</b>		<b>X</b>	
3070	<b>X</b>	<b>X</b>	<b>X</b>	<b>X</b>
4070			<b>X</b>	

\* 20" x 30", 22" x 32", 10' x 10" and 4" x 25" metal lite kits available

\*\*10" x 10" and 4" x 25" rated metal lite kits available

## Decide on Door & Frame Options

### Prehang

Any standard "F" series frame, metal or wood door and hardware may be prehung with hardware applied\*.

\*Closer arms, thresholds and weatherstripping is shipped loose for field installation.

## Factory Prefinished Doors



# Select Your Hardware

Your hardware selection should be guided not only by function, but also the level of use, security, and durability that is required.

- **GRADE 2** hardware is tested to 500,00 cycles and is suitable for light duty usage in commercial buildings such as office doors, side entrances and other light-duty openings
- **GRADE 1** hardware is tested to 1,000,000 cycles and is suitable for heavy-duty applications in schools, hospitals and other high-frequency situations.

**HARDWARE SELECTION** is broken down into it's major door function roles: Hanging, Securing, Controlling, Protecting and Sealing.

## Hang the Door



**EC1100**  
Steel, Standard Wt.,  
5-Knuckle, Plain Bearing



**EC BB1100**  
Steel, Standard Wt.,  
5-Knuckle, Ball Bearing



**BB1191**  
Brass, Standard Wt.,  
5-Knuckle, Ball Bearing

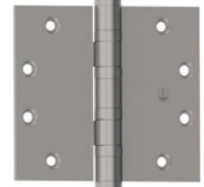

**BB1199**  
Brass, Heavy Wt.,  
5-Knuckle, Plain Bearing

NRP - Non-Removable Pins are available

## Secure the Door



STOCK LOCK FUNCTIONS			
Knob	Lever	Function	Description
		PRIVACY	By both knobs (levers). Can be locked from inside. Emergency opening from outside
		PASSAGE	By both knobs (levers)
		ENTRY	By both knobs (levers) from outside by key. Outside knob (lever) locked or unlocked by inside button.
		CLASSROOM	From outside by knob (lever) except when locked by key, from inside by knob (lever) at all times.
		UTILITY	From outside by key, inside by knob (lever). Outside knob (lever) always rigid.

## LOCK GRADES, STYLES & FINISHES

GRADE 2 Knob	Grade 2 Lever		GRADE 1 Lever	
Hager 3500	Hager 3500	Schlage AL	Schlage ND	Hager I/C Core
Apollo (APL)	Withnell (WTN)	Saturn (SAT)	Rhodes (RHO)	Withnell (WTN)



## DEADLOCK GRADES, FUNCTIONS & FINISHES

	GRADE 2		GRADE 1
	Hager US32D	Schlage US26D	Schlage US 26D
	3215	B560P	B660P
	N.S.	B562P	B662P



## Stand-alone Smart Locks



GRADE 2 chassis



GRADE 1 chassis

## Exit Devices

Rim		Rim		Vertical Rod	
		Fire Rated		Fire Rated	
GRADE 1					
Hager	Hager	Sargent	Sargent	Sargent	Sargent
4701	4501	3828	12-3828	3727	12-3727

### Exit Device Trims

Hager	Sargent
RN	814 (3828 series only)
	810 (pull only)
KE	28-C-LL
KP	
CE	

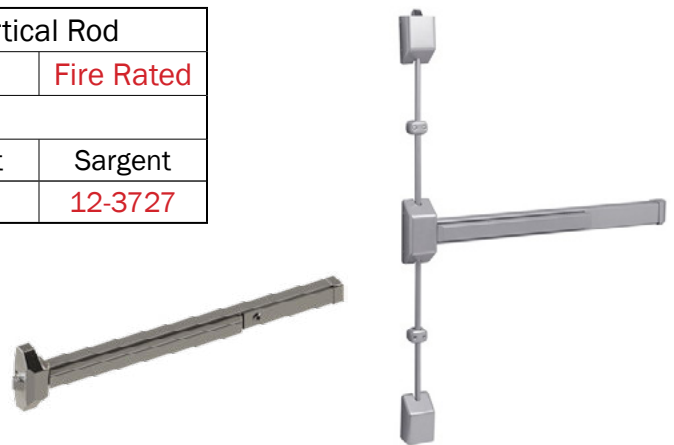

Rim Exit

Vertical Rod Exit



RN  
814



KE  
28-C-LL



KP



CE



# Typical Exit Device Applications

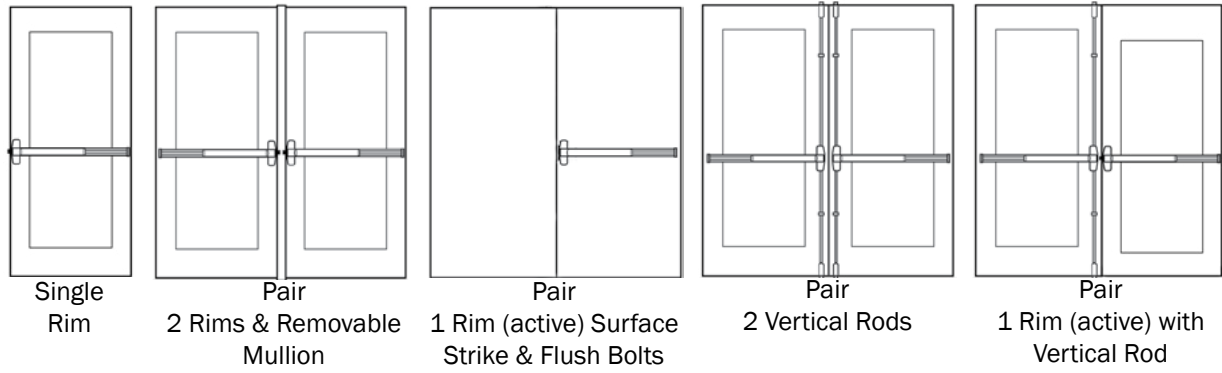

## Control the Door

Manufacturer	Model Number	Use	Body	ADA Compliant	Sweep & Latch Adj.	Back Check	H.O. Option	Warranty
Hager	5300	Interior 250# max. Door	Aluminium Alloy	■	■	■	■	Lifetime
Hager	5200	Interior/Exterior 250# max. Door	Aluminium Alloy	■	■	■	■	Lifetime
Hager	5100	Exterior 330# max Door	Cast Iron	■	■	■	■	Lifetime
LCN	1461	Interior/Med Duty	Cast Iron	■	■	■	■	30 Year
LCN	4040XP	Exterior/High Use	Cast Iron	■	■	■	■	30 Year



Hager 5300

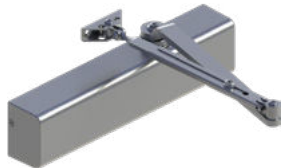

Hager 5200



Hager 5100



LCN 1461



LCN 4040XP

## Protect the Door



Hager  
Push Plate  
30S-4" x 16"



Hager  
Pull Plate  
32E-4" x 16"

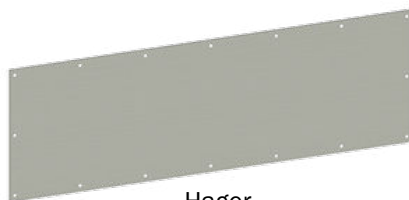

Hager  
Kick Plate  
190 -8" x 30" or 8" x 34"



Hager  
Dome Floor Stop  
241F



Hager  
Wall Stop  
236W



Hager  
Pedestal Floor Stop  
252F



Hager  
Kickdown Door Holder  
270D

## Seal the Door

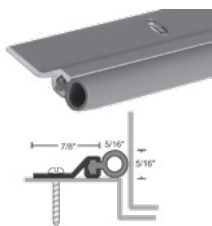

National Guard  
Hd/Jmb Weatherstrip  
160V



National Guard  
Door Bottom Sweep  
200N

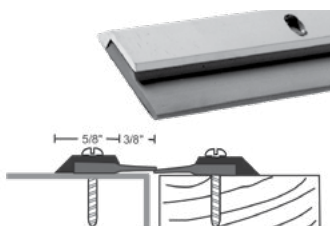

National Guard  
Split Astragal  
115NA



National Guard  
Drip Strip  
16A



National Guard  
ADA Threshold  
424

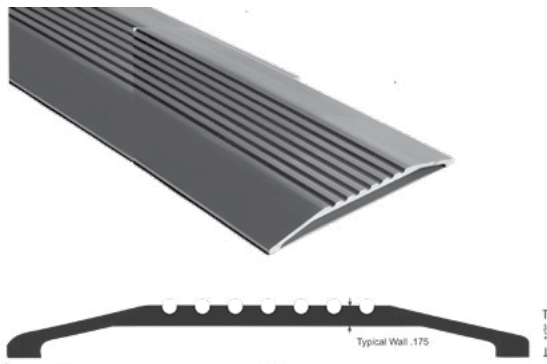

National Guard  
ADA Threshold  
426

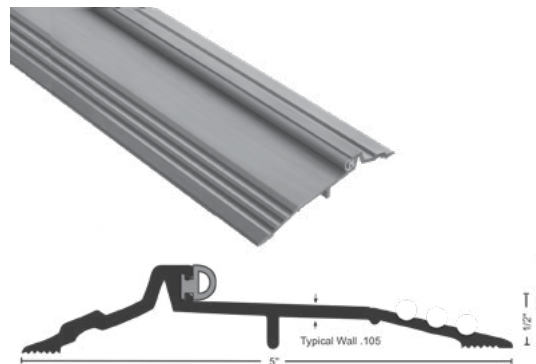

National Guard  
Outswing Threshold  
804V

# Order your Opening Checklist Form

The following checklist will be useful in gathering complete information for quoting/ordering.

## FRAMES

	<input type="checkbox"/> Interior	<input type="checkbox"/> Exterior			
Opening Size:	_____ W X _____ H		<input type="checkbox"/> Nominal Door	<input type="checkbox"/> Rough Opening	<input type="checkbox"/> Existing Opening
Wall Type:	<input type="checkbox"/> New	or	<input type="checkbox"/> Existing	<input type="checkbox"/> Masonry	<input type="checkbox"/> Wood Stud <input type="checkbox"/> Metal Stud
Finished Wall Thickness:	_____				
Frame Type:	<input type="checkbox"/> "F" Series	<input type="checkbox"/> Interior DW Drywall	<input type="checkbox"/> Prefinished Drywall	<input type="checkbox"/> Aluminum	
Frame Construction:	<input type="checkbox"/> KD Knocked Down	<input type="checkbox"/> Welded	Drywall frames must be KD		
Fire Rating:	<input type="checkbox"/> Non-rated	<input type="checkbox"/> 20-minute	<input type="checkbox"/> 45-min "C" Label	<input type="checkbox"/> 90-min "B" Label	<input type="checkbox"/> 3-hour "A" Label
Steel Type:	<input type="checkbox"/> Cold Rolled	<input type="checkbox"/> Galvanized	(typically exterior)		
Handing:	See chart on page 2				

## DOORS

	<input type="checkbox"/> Interior	<input type="checkbox"/> Exterior			
Type:	<input type="checkbox"/> 18Ga HM	<input type="checkbox"/> 20 Ga HM	<input type="checkbox"/> Poly Insul HM	<input type="checkbox"/> Wood	<input type="checkbox"/> Aluminum
Design:	<input type="checkbox"/> Flush	<input type="checkbox"/> G-Half Glass	<input type="checkbox"/> V - 10" x 10"	<input type="checkbox"/> N - 4" x 25"	<input type="checkbox"/> Louver
Fire Rating:	<input type="checkbox"/> Non-rated	<input type="checkbox"/> 20-minute	<input type="checkbox"/> 45-min "C" Label	<input type="checkbox"/> 90-min "B" Label	<input type="checkbox"/> 3-hour "A" Label
HM "Z" Astragal:	<input type="checkbox"/> Yes	<input type="checkbox"/> No			
Top Cap:	<input type="checkbox"/> Yes	<input type="checkbox"/> No	For outswing doors without overhead water protection		

## HARDWARE

Finish:	<input type="checkbox"/> US26D (626)	<input type="checkbox"/> US10 (612)	<input type="checkbox"/> Other: _____
Hinges:	<input type="checkbox"/> Plain Bearing	<input type="checkbox"/> Ball Bearing	<input type="checkbox"/> Heavy Wt <input type="checkbox"/> Brass Base Metal
	ADD Non-removable pins (NRP)		
Locksets:	<input type="checkbox"/> Knob	<input type="checkbox"/> Level	
	<input type="checkbox"/> Standard Duty	<input type="checkbox"/> Heavy Duty	
	<input type="checkbox"/> Passage	<input type="checkbox"/> Privacy	<input type="checkbox"/> Entry <input type="checkbox"/> Classroom <input type="checkbox"/> Utility
Deadlocks:	<input type="checkbox"/> Standard Duty	<input type="checkbox"/> Heavy Duty	
	<input type="checkbox"/> Single Cylinder	<input type="checkbox"/> Double Cylinder	
Exit Devices:	<input type="checkbox"/> Standard Duty	<input type="checkbox"/> Heavy Duty	
	<input type="checkbox"/> Single Door Rim	<input type="checkbox"/> Pair, (2) Rims x Removable Mullion	<input type="checkbox"/> Pair, (1) Rim x Flush Bolts (inactive Door)
	<input type="checkbox"/> Pair, (2) Vert. Rods	<input type="checkbox"/> Rim x Vertical Rod	
	<input type="checkbox"/> Exterior Pull Only	<input type="checkbox"/> Entry with Key	<input type="checkbox"/> Exit Only, No Trim
Protect the Door:	<input type="checkbox"/> Push Plate	<input type="checkbox"/> Pull Plate	<input type="checkbox"/> Kick Plate
	<input type="checkbox"/> Dome Floor Stop	<input type="checkbox"/> Wall Stop	<input type="checkbox"/> Pedestal Floor Stop <input type="checkbox"/> Kickdown Holder
Seal the Door:	<input type="checkbox"/> Hd/Jmb Seal	<input type="checkbox"/> Door Sweep	<input type="checkbox"/> Pair, Split Astragal <input type="checkbox"/> Drip Strip
	<input type="checkbox"/> 4" ADA Threshold	<input type="checkbox"/> 6" ADA Threshold	<input type="checkbox"/> Outswing Threshold

# Existing Frame 1-3/4" Door Thickness

Strike Length:

4-7/8"  2-3/4"

Hinge Size: \_\_\_\_\_ x \_\_\_\_\_

Hinge Backset on FRAME: \_\_\_\_\_

Lock Backset:

2-3/4"  2-3/8"

Lock Prep:

2-1/8" \_\_\_\_\_ Other

8" Edge Only Prep - 86ED

Hinge Backset on Door: \_\_\_\_\_

Dimensions from FRAME:

A1 \_\_\_\_\_ A2 \_\_\_\_\_ A3 \_\_\_\_\_ B \_\_\_\_\_

C \_\_\_\_\_ D \_\_\_\_\_

E \_\_\_\_\_ E1 \_\_\_\_\_

F \_\_\_\_\_ G \_\_\_\_\_ H \_\_\_\_\_ I \_\_\_\_\_

Wall Type:  Masonry  Wood Stud  Steel Stud

Special Hardware: \_\_\_\_\_  
 \_\_\_\_\_  
 \_\_\_\_\_

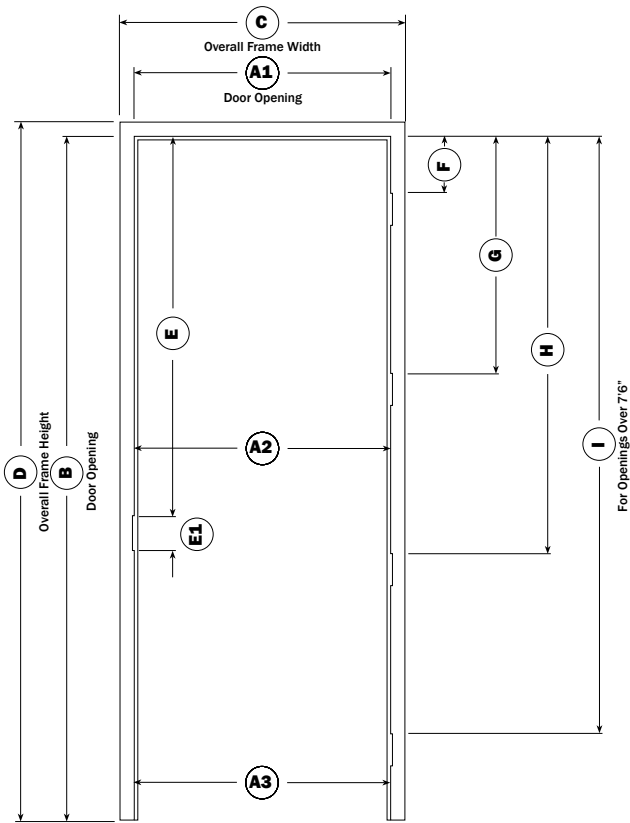
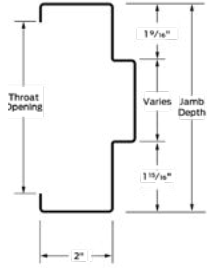

The handing of an opening is determined from the OUTSIDE or KEY SIDE unless otherwise specified

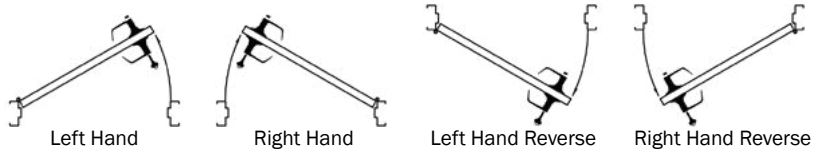

# Existing Door 1-3/4" Door Thickness

Hinge Size: \_\_\_\_\_ x \_\_\_\_\_

Hinge Backset on DOOR: \_\_\_\_\_

Lock Backset:

2-3/4"  2-3/8"

Lock Prep:

2-1/8" \_\_\_\_\_ Other

8" Edge Only Prep - 86ED

Dimensions from DOOR:

A \_\_\_\_\_ B \_\_\_\_\_

C \_\_\_\_\_

D \_\_\_\_\_ E \_\_\_\_\_ F \_\_\_\_\_ G \_\_\_\_\_

Special Hardware: \_\_\_\_\_  
 \_\_\_\_\_  
 \_\_\_\_\_  
 \_\_\_\_\_

